

DOT ENTRANCE DRAWINGS FOR PIT STOP GEORGIA HIGHWAY 138 AT GEORGIA HIGHWAY 314

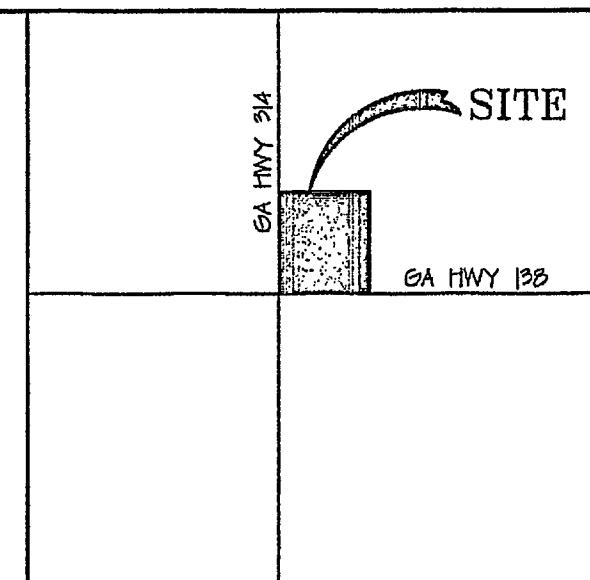

VICINITY MAP
NOT TO SCALE

**BRUNDAGE
ENGINEERING, INC.**
P.O. BOX 1926
FAYETTEVILLE,
GA. 30214
770-719-0433

SITE
DEVELOPMENT
DRAWINGS
FOR

PIT STOP
(DOT ENTRANCE
DRAWINGS)

LOCATED IN
L.L. 186
OF THE 13th DISTRICT
CLAYTON COUNTY,
GEORGIA

- NOTES:**
- OWNER/DEVELOPER: THE PROPERTIES, LLLP
100 PETROL POINT
PEACHTREE CITY, GA. 30149
770-487-9997
CONTACT: MIKE HYDE
 - ZONING: ND AND GP
MINIMUM LOT AREA - 10,000 SF
MINIMUM LOT WIDTH - 100'
FRONT SETBACK - 50'
REAR SETBACK - 0'
SIDE SETBACK - 0'
HEIGHT LIMIT - 35' (ND), 75' (GP)
 - BOUNDARY AND TOPOGRAPHIC SURVEY BY W.S. DODKIN SURVEYING, LLC.
 - THIS PROPERTY DOES NOT INCLUDE A FLOOD HAZARD AREA ACCORDING TO FIRM NO. 190241 DATED NOV. 6, 1991.
 - ACREAGE OF SITE - 142 AC.
 - TAX ID NUMBER - 12866 D001
 - REQUIRED PARKING-
GASOLINE SERVICE STATION - 2 SPACES PER GAS PUMP PLUS 3 SPACES FOR EACH SERVICE BAY OR SIMILAR FACILITY PLUS 1 SPACE FOR EACH ATTENDANT & PUMP ISLANDS X 2 SPACES/PUMP = 12 SPACES (THESE SPACES ARE LOCATED ADJACENT TO EACH PUMP ISLAND AND ARE NOT INCLUDED IN THE FOLLOWING CALCULATIONS)
1 FUELING ATTENDANT X 1 SPACE/ATTENDANT = 1 SPACE
RETAIL STORE UPPER LEVEL - 1 SPACE PER 300 SQ. FT. OF GROSS FLOOR AREA
3500 SQ. FT. X 1 SPACE/300 SQ. FT. = 12 SPACES
RETAIL STORE LOWER LEVEL - 1 SPACE PER 300 SQ. FT. OF GROSS FLOOR AREA
3500 SQ. FT. X 1 SPACE/300 SQ. FT. = 12 SPACES
TOTAL SPACES REQUIRED = 25 SPACES
TOTAL PARKING PROPOSED = 26 SPACES
HANDICAP SPACES REQUIRED = 2 SPACES
HANDICAP SPACES PROPOSED = 2 SPACES

- LEGEND**
- (Co) CONSTRUCTION EXIT
 - (Fr) FILTER RING
 - (Rd) ROCK DAM
 - (Re) RETAINING WALL
 - (Rt) RETROFIT
 - (Sd) SEDIMENT BARRIER
 - (Sdp) TEMPORARY SEDIMENT BASIN
 - (St) STORM DRAIN OUTLET PROTECTION
 - (Ds2) DISTURBED AREA STABILIZATION (WITH TEMPORARY SEEDING)
 - (Ds3) DISTURBED AREA STABILIZATION (WITH PERMANENT VEGETATION)

- GENERAL LEGEND**
- E/P --- EXISTING EDGE OF PAVEMENT
 - 930 --- EXISTING CONTOUR
 - 930 --- NEW CONTOUR
 - W --- EXISTING WATER LINE
 - OHE --- EXISTING OVERHEAD ELECTRIC LINE
 - ⇒ DIRECTION OF TRAFFIC
 - ⇒ PAINTED TRAFFIC ARROW
 - EXISTING SIGN
 - NEW SIGN
 - ▲ EXISTING FIRE HYDRANT
 - ⊠ RELOCATED FIRE HYDRANT
 - ⊠ PP EXISTING POWER/UTILITY POLE
 - ⊠ CP CONCRETE STRAIN POLE
 - WSP WOOD STRAIN POLE
 - GW GUY WIRE

SCHEDULE OF DRAWINGS

NO.	DRAWING
1	COVER
2	DOT ENTRANCE LAYOUT PLAN
3	GRADING PLAN
4	EROSION AND SEDIMENTATION CONTROL PLAN
5	EROSION AND SEDIMENTATION CONTROL DETAILS

DATE	JOB NO.
JANUARY 18, 2005	00027
FILE NAME	SCALE
PITSTOP2rev6	NOT TO SCALE
SHEET TITLE	

COVER



NO.	REVISIONS	DATE

SHEET NO.
1
SHEET 1 OF 5
 RELEASED FOR CONSTRUCTION
 FOR REVIEW ONLY

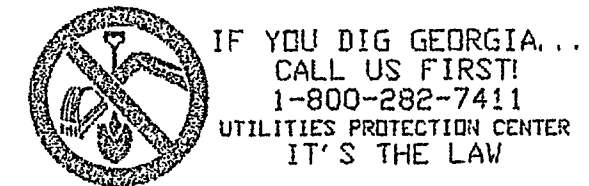

BRUNDAGE ENGINEERING, INC.
 P.O. BOX 1926
 FAYETTEVILLE, GA. 30214
 770-719-0433

SITE DEVELOPMENT DRAWINGS FOR

PIT STOP (DOT ENTRANCE DRAWINGS)

LOCATED IN
 L.L. 186
 OF THE 13th DISTRICT
 CLAYTON COUNTY,
 GEORGIA

DATE: JANUARY 18, 2005
 JOB NO.: 00027
 FILE NAME: PITSTOPREV6
 SCALE: 1" = 20'

SHEET TITLE
DOT ENTRANCE LAYOUT PLAN



NO.	REVISIONS	DATE

SHEET NO. **2**
 SHEET 2 OF 5
 RELEASED FOR CONSTRUCTION
 FOR REVIEW ONLY

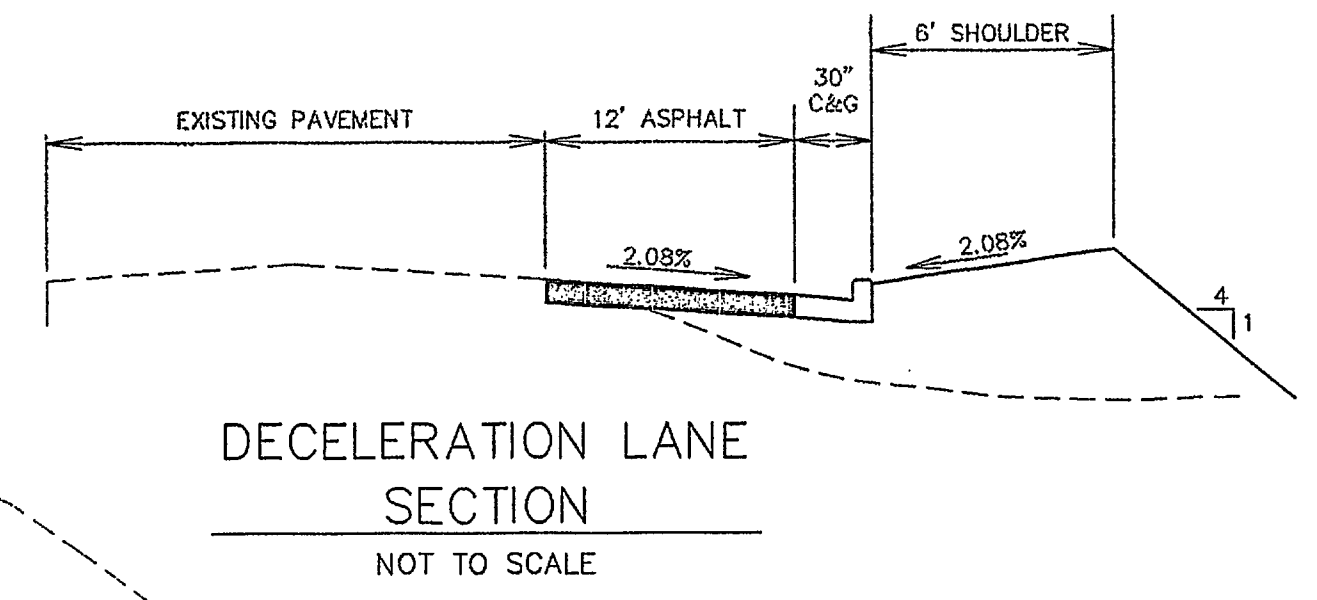
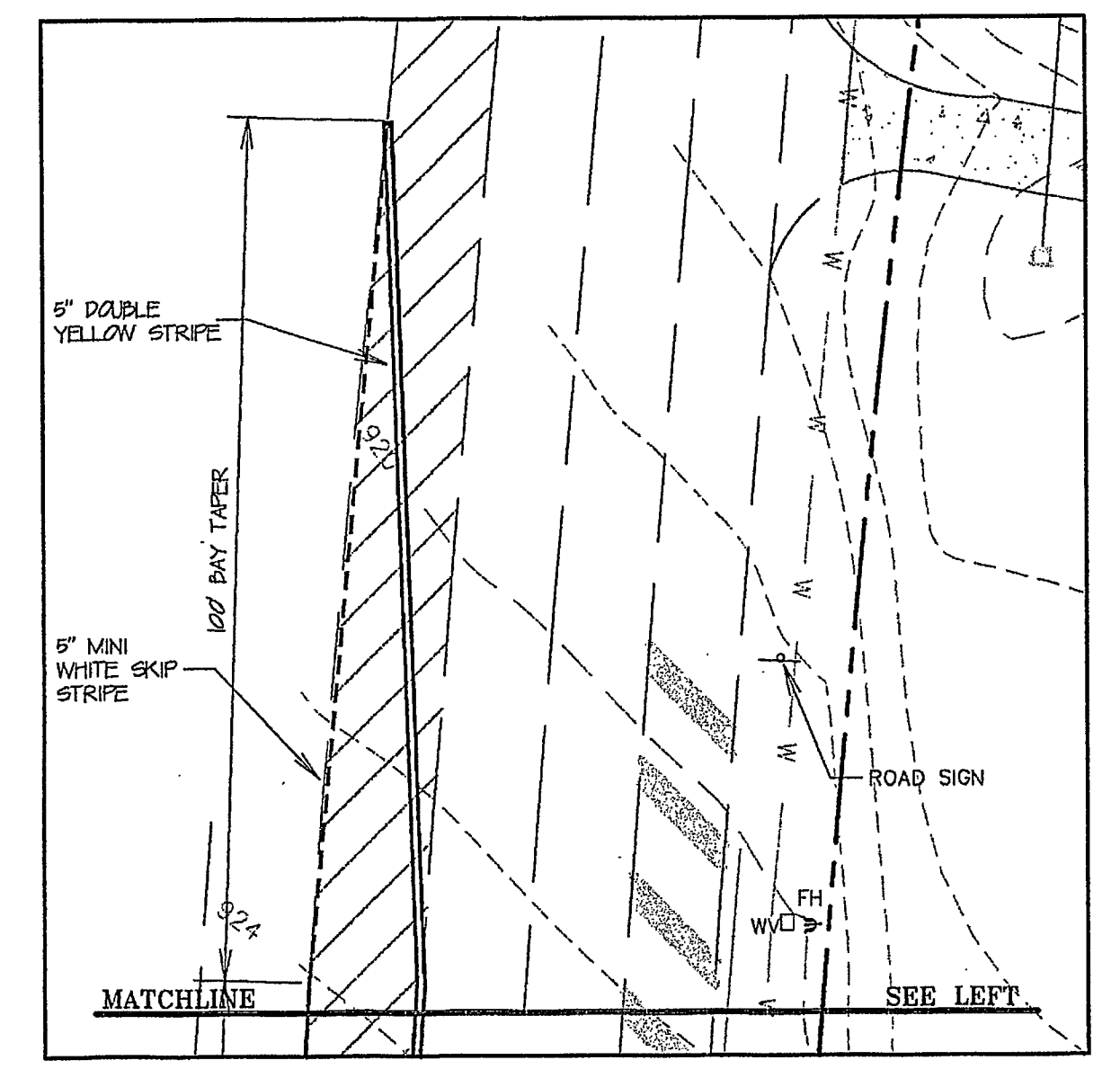
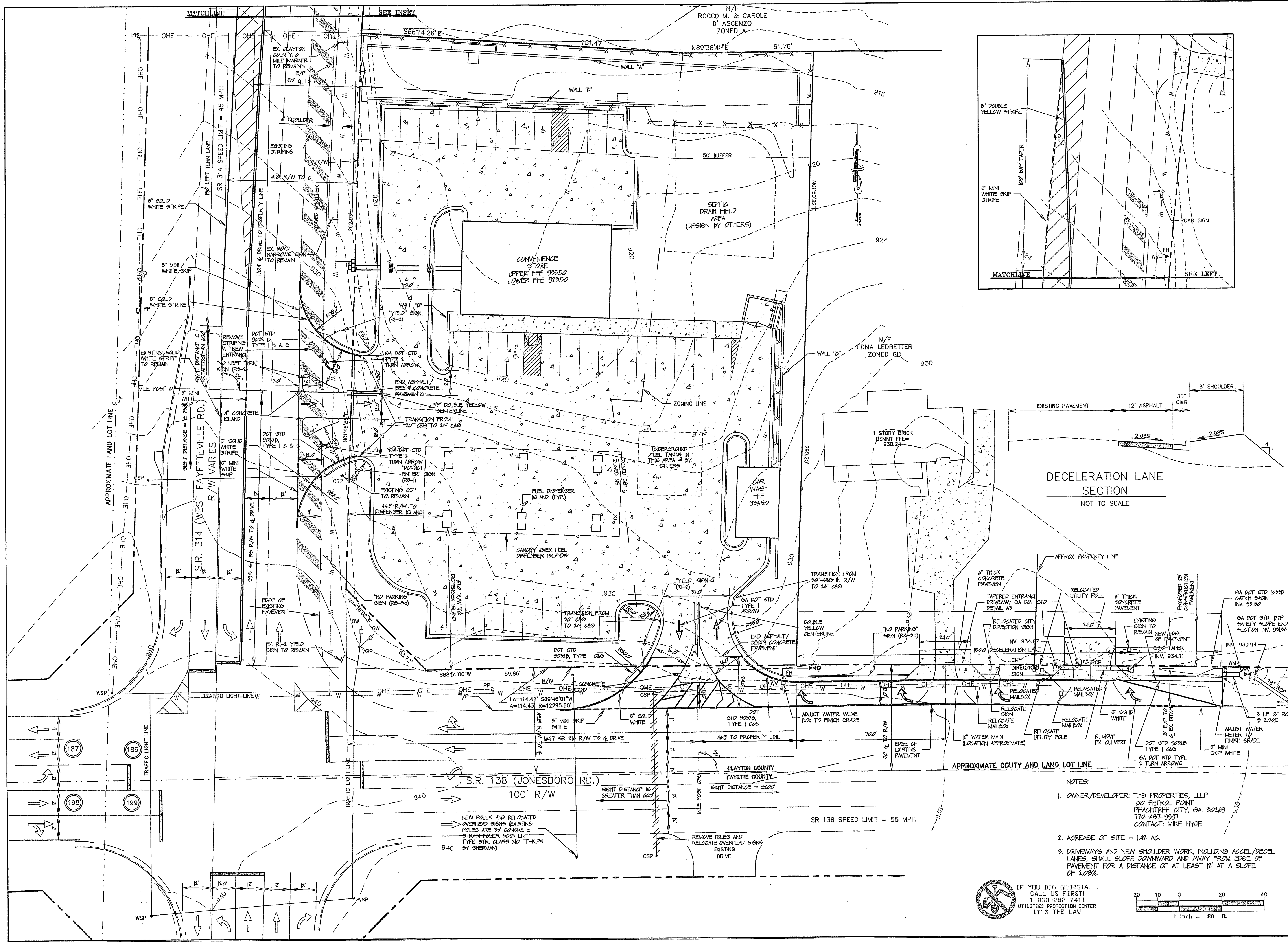

- NOTES:**
- OWNER/DEVELOPER: THE PROPERTIES, LLLP
 100 PETROL POINT
 PEACHTREE CITY, GA 30109
 770-457-9971
 CONTACT: MIKE HYDE
 - ACREAGE OF SITE - 142 AC.
 - DRIVEWAYS AND NEW SHOULDER WORK, INCLUDING ACCEL/DECEL LANES, SHALL SLOPE DOWNWARD AND AWAY FROM EDGE OF PAVEMENT FOR A DISTANCE OF AT LEAST 12' AT A SLOPE OF 2.08%.

IF YOU DIG GEORGIA...
 CALL US FIRST!
 1-800-282-7411
 UTILITIES PROTECTION CENTER
 IT'S THE LAW

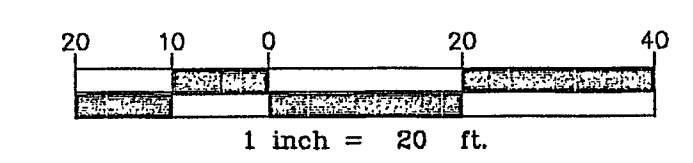

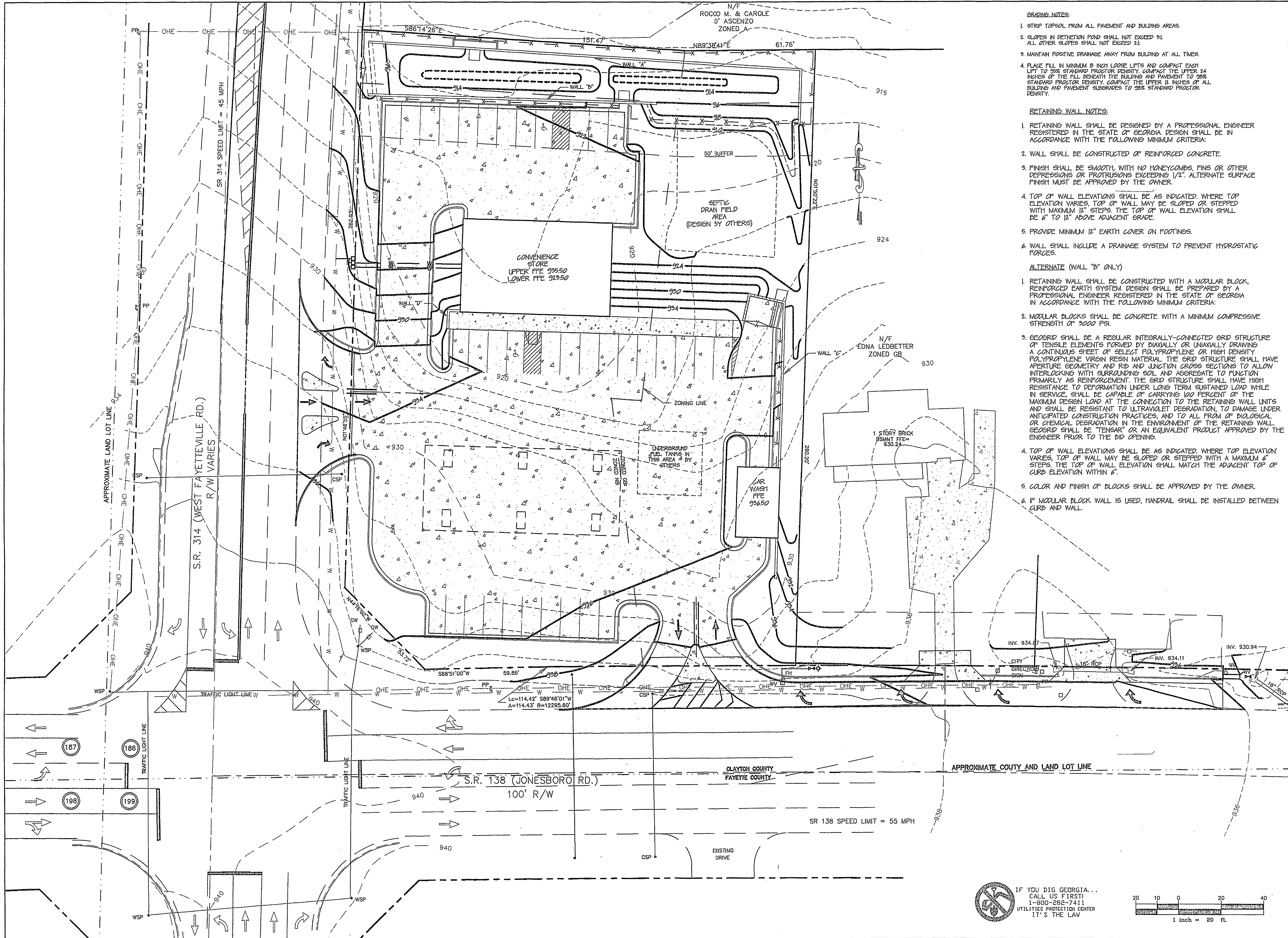

- GRADING NOTES:**
- STRIP TOPSOIL FROM ALL PAVEMENT AND BUILDING AREAS.
 - SLOPES IN DETENTION POND SHALL NOT EXCEED 3:1. ALL OTHER SLOPES SHALL NOT EXCEED 2:1.
 - MAINTAIN POSITIVE DRAINAGE AWAY FROM BUILDING AT ALL TIMES.
 - PLACE FILL IN MINIMUM 8" INCH LOOSE LIFTS AND COMPACT EACH LIFT TO 98% STANDARD PROCTOR DENSITY. COMPACT THE UPPER 24" INCHES OF THE FILL BENEATH THE BUILDING AND PAVEMENT TO 98% STANDARD PROCTOR DENSITY. COMPACT THE UPPER 12" INCHES OF ALL BUILDING AND PAVEMENT SUBGRADES TO 98% STANDARD PROCTOR DENSITY.

- RETAINING WALL NOTES:**
- RETAINING WALL SHALL BE DESIGNED BY A PROFESSIONAL ENGINEER REGISTERED IN THE STATE OF GEORGIA. DESIGN SHALL BE IN ACCORDANCE WITH THE FOLLOWING MINIMUM CRITERIA:
 - WALL SHALL BE CONSTRUCTED OF REINFORCED CONCRETE.
 - FINISH SHALL BE SMOOTH, WITH NO HONEYCOMBS, FINS OR OTHER DEPRESSIONS OR PROTRUSIONS EXCEEDING 1/2". ALTERNATE SURFACE FINISH MUST BE APPROVED BY THE OWNER.
 - TOP OF WALL ELEVATIONS SHALL BE AS INDICATED. WHERE TOP ELEVATION VARIES, TOP OF WALL MAY BE SLOPED OR STEPPED WITH MAXIMUM 12" STEPS. THE TOP OF WALL ELEVATION SHALL BE 6" TO 12" ABOVE ADJACENT GRADE.
 - PROVIDE MINIMUM 12" EARTH COVER ON FOOTINGS.
 - WALL SHALL INCLUDE A DRAINAGE SYSTEM TO PREVENT HYDROSTATIC FORCES.

- ALTERNATE (WALL "B" ONLY)**
- RETAINING WALL SHALL BE CONSTRUCTED WITH A MODULAR BLOCK, REINFORCED EARTH SYSTEM. DESIGN SHALL BE PREPARED BY A PROFESSIONAL ENGINEER REGISTERED IN THE STATE OF GEORGIA. IN ACCORDANCE WITH THE FOLLOWING MINIMUM CRITERIA:
 - MODULAR BLOCKS SHALL BE CONCRETE WITH A MINIMUM COMPRESSIVE STRENGTH OF 3000 PSI.
 - GEORID SHALL BE A REGULAR INTEGRALLY-CONNECTED GRID STRUCTURE OF TENSILE ELEMENTS FORMED BY BIAXIALLY OR UNIAXIALLY DRAWING A CONTINUOUS SHEET OF SELECT POLYPROPYLENE OR HIGH DENSITY POLYPROPYLENE VIRGIN RESIN MATERIAL. THE GRID STRUCTURE SHALL HAVE APERTURE GEOMETRY AND RID AND JUNCTION CROSS SECTIONS TO ALLOW INTERLOCKING WITH SURROUNDING SOIL AND AGGREGATE TO FUNCTION PRIMARILY AS REINFORCEMENT. THE GRID STRUCTURE SHALL HAVE HIGH RESISTANCE TO DEFORMATION UNDER LONG TERM SUSTAINED LOAD WHILE IN SERVICE, SHALL BE CAPABLE OF CARRYING 100 PERCENT OF THE MAXIMUM DESIGN LOAD AT THE CONNECTION TO THE RETAINING WALL UNITS AND SHALL BE RESISTANT TO ULTRAVIOLET DEGRADATION, TO DAMAGE UNDER ANTICIPATED CONSTRUCTION PRACTICES, AND TO ALL FORMS OF BIOLOGICAL OR CHEMICAL DEGRADATION IN THE ENVIRONMENT OF THE RETAINING WALL. GEORID SHALL BE "TENSAR" OR AN EQUIVALENT PRODUCT APPROVED BY THE ENGINEER PRIOR TO THE BID OPENING.
 - TOP OF WALL ELEVATIONS SHALL BE AS INDICATED. WHERE TOP ELEVATION VARIES, TOP OF WALL MAY BE SLOPED OR STEPPED WITH A MAXIMUM 6" STEPS. THE TOP OF WALL ELEVATION SHALL MATCH THE ADJACENT TOP OF CURB ELEVATION WITHIN 6".
 - COLOR AND FINISH OF BLOCKS SHALL BE APPROVED BY THE OWNER.
 - IF MODULAR BLOCK WALL IS USED, HANDRAIL SHALL BE INSTALLED BETWEEN CURB AND WALL.

BRUNDAGE ENGINEERING, INC.
 P.O. BOX 1926
 FAYETTEVILLE, GA. 30214
 770-719-0439

SITE DEVELOPMENT DRAWINGS FOR PIT STOP (DOT ENTRANCE DRAWINGS)

LOCATED IN L.L. 186 OF THE 13th DISTRICT CLAYTON COUNTY, GEORGIA

DATE: JANUARY 18, 2005
 JOB NO.: 00027
 FILE NAME: PITSTOP2rev6
 SCALE: 1" = 20'
 SHEET TITLE: GRADING PLAN

GRADING PLAN

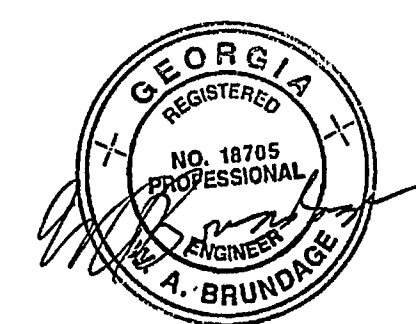

NO.	REVISIONS	DATE

SHEET NO. **3**
 SHEET 3 OF 5
 RELEASED FOR CONSTRUCTION
 FOR REVIEW ONLY

IF YOU DIG GEORGIA... CALL US FIRST!
 1-800-282-7411
 UTILITIES PROTECTION CENTER
 IT'S THE LAW

BRUNDAGE ENGINEERING, INC.
 P.O. BOX 1926
 FAYETTEVILLE, GA. 30214
 770-719-0433

SITE DEVELOPMENT DRAWINGS FOR PIT STOP (DOT ENTRANCE DRAWINGS)

LOCATED IN
 L.L. 186
 OF THE 13th DISTRICT
 CLAYTON COUNTY,
 GEORGIA

DATE: JANUARY 18, 2005
 JOB NO.: 00027
 FILE NAME: PITSTOP2rev6
 SCALE: 1" = 20'

EROSION AND SEDIMENTATION CONTROL PLAN

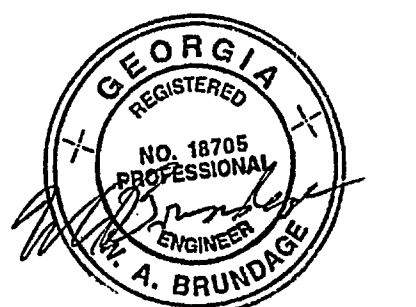

NO.	REVISIONS	DATE

SHEET NO. **4**
 SHEET 4 OF 5
 RELEASED FOR CONSTRUCTION
 FOR REVIEW ONLY

- LEGEND**
- (Cd) CHECK DAM
 - (Co) CONSTRUCTION EXIT
 - (Fr) FILTER RING
 - (Lv) LEVEL SPREADER
 - (Rw) RETAINING WALL
 - (Rt) RETROFIT
 - (St) STORM DRAIN OUTLET PROTECTION
 - (Sd) SEDIMENT BARRIER
 - (Sdb) TEMPORARY SEDIMENT BASIN
 - (Ds2) DISTURBED AREA STABILIZATION (WITH TEMPORARY SEEDING)
 - (Ds3) DISTURBED AREA STABILIZATION (WITH PERMANENT VEGETATION)
 - (Mb) MATTINGS AND BLANKETS - (CURLLEX | EROSION BLANKET)

- EROSION AND SEDIMENT CONTROL NOTES**
- SEDIMENT CONTROL MEASURES MUST BE INSTALLED BEFORE CLEARING AND GRADING BEGINS.
 - ALL EROSION CONTROL MEASURES ARE AT A MINIMUM, SHALL CONFORM TO THE STANDARDS SET FORTH IN THE MANUAL FOR EROSION AND SEDIMENT CONTROL IN GEORGIA.
 - EROSION CONTROL MEASURES SHOWN HEREON ARE MINIMUM REQUIREMENTS. ADDITIONAL MEASURES MAY BE NEEDED IN ORDER TO CONTROL SEDIMENT AS REQUIRED BY LAW, CHANGES AND REINFORCEMENT IS REQUIRED WHEN FAILURE OF THE EROSION CONTROL MEASURE PERSISTS.
 - EROSION CONTROL MEASURES MUST BE MAINTAINED AT ALL TIMES. INSPECTION AND REPAIR OF EROSION CONTROL MEASURES IS REQUIRED ONCE A WEEK AND AFTER EACH RAIN EVENT.
 - 24 HOUR CONTACT - LARRY HALL 770-775-1700
 - SEDIMENT SHALL BE REMOVED FROM SEDIMENT BARRIERS WHEN SEDIMENT REACHES ONE HALF THE HEIGHT OF THE BARRIER.
 - TOTAL DISTURBED AREA = 14 ACRES
 - THE SOILS ON THIS SITE ARE DESIGNATED POC AND ASC, ON THE "SOIL SURVEY OF CLAYTON, FAYETTE AND HENRY COUNTIES, GEORGIA."
 - THERE ARE NO STATE WATERS LOCATED WITHIN 200 FEET OF THE PROPERTY.

PROJECT DESCRIPTION
 THE SITE IS CURRENTLY WOODED. PROPOSED ACTIVITIES INCLUDE CLEARING, AND GRUBBING, GRADING, CONSTRUCTION OF STORMWATER PIPES, PAVING, UTILITY CONSTRUCTION AND GRASSING.

EROSION CONTROL MEASURES WILL BE MAINTAINED AT ALL TIMES. IF FULL IMPLEMENTATION OF THE APPROVED PLAN DOES NOT PROVIDE FOR EFFECTIVE EROSION CONTROL, ADDITIONAL EROSION AND SEDIMENT CONTROL MEASURES SHALL BE IMPLEMENTED TO CONTROL OR TREAT THE SEDIMENT SOURCE.

THE ESCAPE OF SEDIMENT FROM THE SITE SHALL BE PREVENTED BY THE INSTALLATION OF EROSION CONTROL MEASURES AND PRACTICES PRIOR TO, OR CONCURRENT WITH, LAND DISTURBING ACTIVITIES.

(Sdb) TEMPORARY SEDIMENT BASIN CALCULATIONS
 ON-SITE DRAINAGE AREA = 14 AC.
 REQUIRED SEDIMENT VOLUME = 14 AC X 67 CY/AC = 94 CY
 SEDIMENT STORAGE ELEV. = 930.0
 CLEANOUT VOLUME = 14 AC X 22 CY/AC = 308 CY
 CLEANOUT ELEV. = 945

ACTIVITY SCHEDULE

	MARCH	APRIL	MAY	JUNE	JULY
INSTALL EROSION CONTROL	03/15				
CLEARING	03/15-03/20				
GRADING	03/20-04/05				
DETENTION/SEDIMENT POND CONSTRUCTION	03/20-04/05				
GRASSING - SLOPES			05/01		
STORM DRAIN	03/20-04/05				
WATER LINES		04/15-04/20			
CURBING/PAVING		04/20-05/05			
PERMANENT GRASSING				06/01	
BUILDING CONSTRUCTION			06/01-06/15		
MAINTAIN EROSION CONTROL	03/15-07/15				

(Ds2) (Ds3)
VEGETATIVE PLAN FOR GRASSING
 TEMPORARY GRASSING FOR MARCH-APRIL - ANNUAL RYE GRASS (LULIA TEMULENTUM) APPLY SEED AT 40 LBS./ACRE, TOP DRESS FERTILIZER AT 500 LBS./ACRE OF 10-10-10 LIME TO BE APPLIED AT 1 TON/ACRE (APPLY LIME WITH FERTILIZER APPLICATION) AND DRY STRAW MULCH AT 2 TONS/ACRE IMMEDIATELY AFTER APPLICATION OF SEED AND FERTILIZER/LIME.
 TEMPORARY GRASSING FOR MAY-JULY - PEARL MILLET (PENNESETUM GLABRUM) APPLY SEED AT 50 LBS./ACRE, TOP DRESS FERTILIZER AT 500 LBS./ACRE OF 10-10-10 LIME TO BE APPLIED AT 1 TON/ACRE (APPLY LIME WITH FERTILIZER APPLICATION) AND DRY STRAW MULCH AT 2 TONS/ACRE IMMEDIATELY AFTER APPLICATION OF SEED AND FERTILIZER/LIME.
 PERMANENT GRASSING FOR SEPTEMBER - COMMON PERNUDA - MULLED (COMMON CACTYON) APPLY SEED AT 20 LBS./ACRE, TOPDRESS FERTILIZER AT 500 LBS./ACRE OF 10-10-10 LIME TO BE APPLIED AT 1 TON/ACRE (APPLY LIME WITH FERTILIZER APPLICATION) AND APPLY DRY STRAW MULCH AT 2 TONS/ACRE IMMEDIATELY AFTER APPLICATION OF SEED AND FERTILIZER/LIME.
 SEE MANUAL FOR EROSION AND SEDIMENT CONTROL IN GEORGIA FOR STATE APPROVED GRASSING SPECIFICATIONS IF CONSTRUCTION SCHEDULE IS DIFFERENT THAN INDICATED.

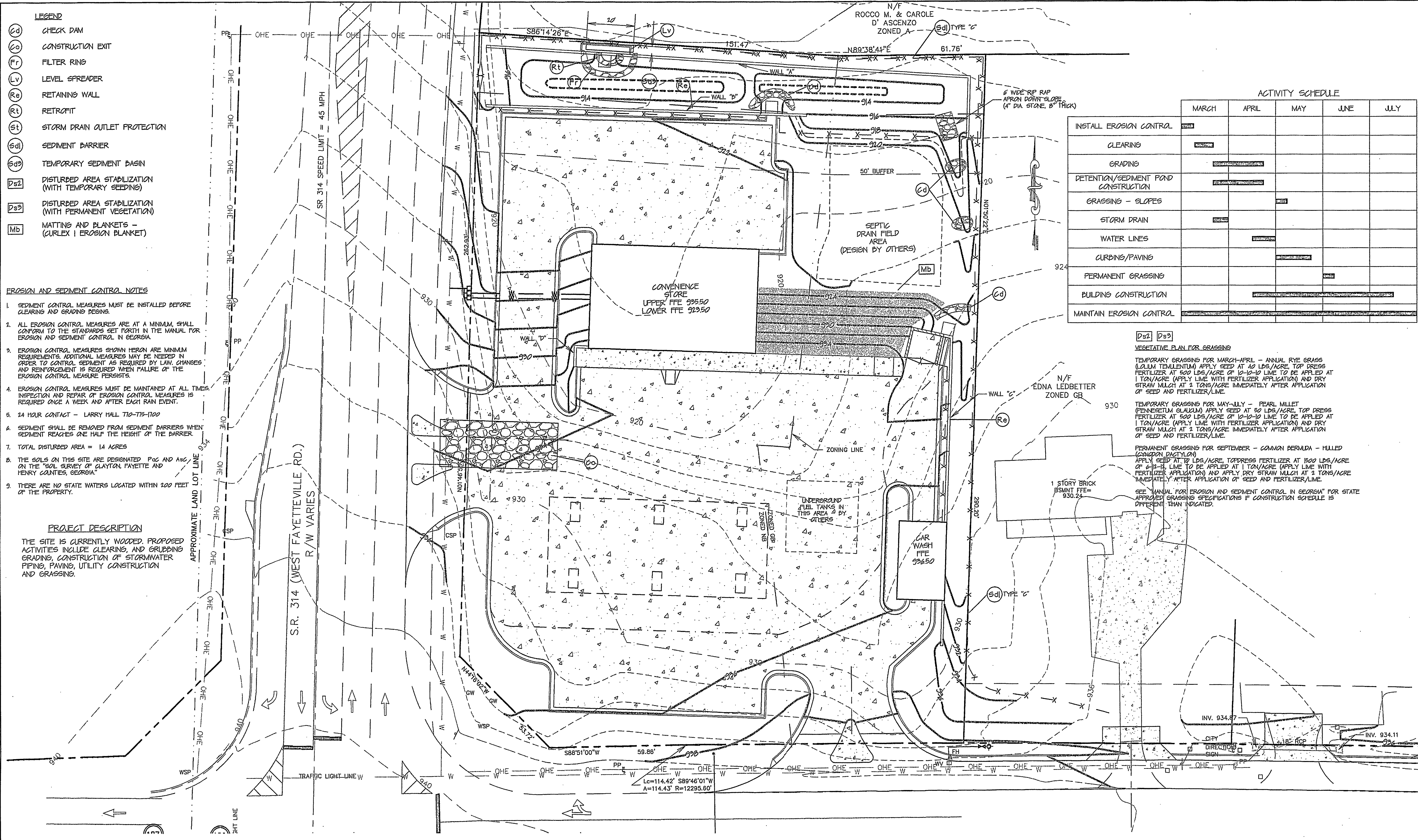

IF YOU DIG GEORGIA...
 CALL US FIRST!
 1-800-282-7411
 UTILITIES PROTECTION CENTER
 IT'S THE LAW

SPECIFICATIONS

- A. GRADING AND SHAPING**
- EXCESSIVE WATER RUNOFF MUST BE CONTROLLED BY PLANNED AND INSTALLED EROSION CONTROL PRACTICES SUCH AS CLOSED DRAINS, DITCHES, DIVERSIONS, SEDIMENT BASINS AND OTHERS.
 - NO SHAPING OR GRADING IS REQUIRED IF SLOPES CAN BE STABILIZED BY HAND-SEEDED VEGETATION OR IF HYDRAULIC SEEDING EQUIPMENT IS TO BE USED.
- B. SEEDBED PREPARATION**
- WHEN A HYDRAULIC SEEDER IS USED, SEEDBED PREPARATION IS NOT REQUIRED.
 - WHEN USING CONVENTIONAL OR HAND-SEEDING, SEEDBED PREPARATION IS NOT REQUIRED IF THE SOIL MATERIAL IS LOOSE AND NOT SEALED BY RAINFALL.
 - WHEN SOIL HAS BEEN SEALED BY RAINFALL OR CONSISTS OF SMOOTH UNDISTURBED CUT SLOPES, THE SOIL SHALL BE PITTED, TRENCHED OR OTHERWISE SCARIFIED TO PROVIDE A PLACE FOR SEED TO LODGE AND GERMINATE.
- C. LIME AND FERTILIZER**
- AGRICULTURAL LIME IS NOT REQUIRED.
 - ON REASONABLY FERTILE SOILS OR SOIL MATERIAL, FERTILIZER IS NOT REQUIRED.
 - ON SOILS OF VERY LOW FERTILITY, USE 500 TO 700 POUNDS 10-10-10 FERTILIZER OR THE EQUIVALENT PER ACRE (12-16 lbs./1000 sq. ft.). IF THE SITE WILL PERMIT, APPLY BEFORE LAND PREPARATION AND DISK, RIP OR CHISEL TO INCORPORATE.
- D. SEEDING**
- SELECT A GRASS OR GRASS-LEGUME MIXTURE SUITABLE TO THE AREA AND SEASON OF THE YEAR.
 - APPLY SEED UNIFORMLY BY HAND, CYCLONE SEEDER, DRILL, CULTIPACKER-SEEDER, OR HYDRAULIC SEEDER (SLURRY INCLUDING SEED AND FERTILIZER). DRILL OR CULTIPACKER-SEEDERS SHOULD NORMALLY PLACE SEED ONE-HALF TO ONE INCH DEEP.
- E. MULCHING**
- TEMPORARY VEGETATION CAN, IN MOST CASES, BE ESTABLISHED WITHOUT THE USE OF MULCH. MULCH WITHOUT SEEDING SHOULD BE CONSIDERED FOR SHORT TERM PROTECTION. SEE Ds1 - DISTURBED AREA STABILIZATION (WITH TEMPORARY SEEDLINGS).
- F. IRRIGATION**
- IF WATER IS APPLIED, IT MUST BE AT A RATE NOT CAUSING RUNOFF AND EROSION. THOROUGHLY WET THE SOIL TO A DEPTH THAT WILL INSURE GERMINATION OF THE SEED. SUBSEQUENT APPLICATIONS SHOULD BE MADE WHEN NEEDED.

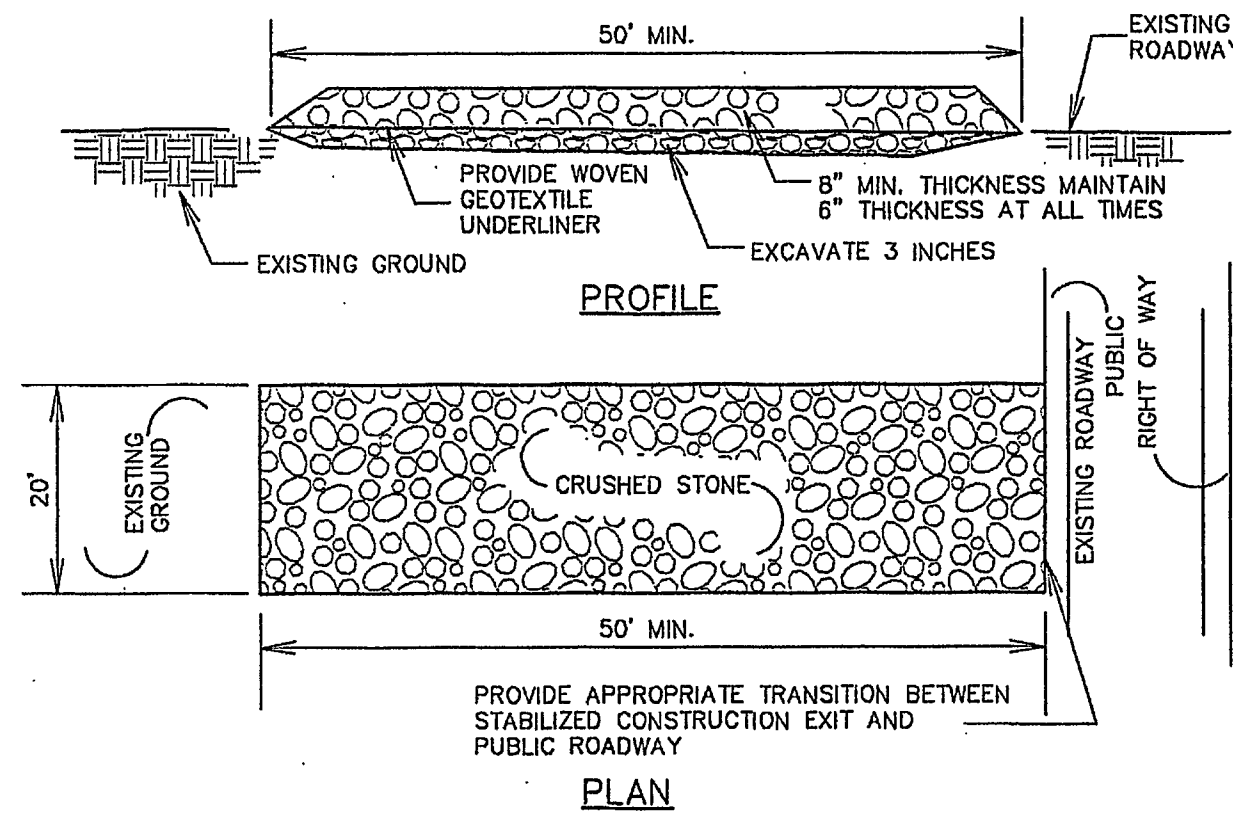

CONSTRUCTION SPECIFICATIONS:

- STONE SIZE - USE 1.5" TO 3.5" CRUSHED STONE.
- LENGTH - AS EFFECTIVE, BUT NOT LESS THAN 50'.
- THICKNESS - NOT LESS THAN EIGHT (8) INCHES.
- WIDTH - NOT LESS THAN FULL WIDTH OF ALL POINTS OF INGRESS OR EGRESS.
- WASHING - WHEN NECESSARY, WHEELS SHALL BE CLEANED TO REMOVE SEDIMENT PRIOR TO ENTRANCE ONTO PUBLIC RIGHTS-OF-WAY. WHEN WASHING IS REQUIRED IT SHALL BE DONE ON AN AREA STABILIZED WITH CRUSHED STONE WHICH DRAINS INTO AN APPROVED SEDIMENT TRAP OR SEDIMENT BASIN. ALL SEDIMENT SHALL BE PREVENTED FROM ENTERING ANY STORM DRAIN, DITCH, OR WATERCOURSE THROUGH THE USE OF SAND BAGS, GRAVEL, BOARDS, OR OTHER APPROVED METHODS.
- MAINTENANCE - THE ENTRANCE SHALL BE MAINTAINED IN A CONDITION WHICH WILL PREVENT TRACKING OR FLOWING OF SEDIMENT ONTO PUBLIC RIGHTS-OF-WAY. THIS MAY REQUIRE PERIODIC TOP DRESSING WITH ADDITIONAL STONE AS CONDITIONS DEMAND, AND REPAIR AND/OR CLEANOUT OF ANY MEASURES USED TO TRAP SEDIMENT. ALL SEDIMENT SPILLED, DROPPED, WASHED, OR TRACKED ONTO PUBLIC RIGHTS-OF-WAY MUST BE REMOVED IMMEDIATELY.

(Co) STONE PAD CONSTRUCTION EXIT

NOT TO SCALE

SPECIFICATIONS

- A. GRADING AND SHAPING**
- GRADING AND SHAPING IS NOT NORMALLY REQUIRED WHERE HYDRAULIC SEEDING AND FERTILIZING EQUIPMENT IS TO BE USED. VERTICAL BANKS SHALL BE SLOPED TO ENABLE PLANT ESTABLISHMENTS.
 - WHEN CONVENTIONAL SEEDING AND FERTILIZING IS TO BE DONE, GRADE AND SHAPE WHERE FEASIBLE AND PRACTICAL SO THAT EQUIPMENT CAN BE USED SAFELY AND EFFICIENTLY DURING SEEDBED PREPARATION, SEEDING, MULCHING AND MAINTENANCE OF THE VEGETATION.
 - CONCENTRATIONS OF WATER THAT WILL CAUSE EXCESSIVE SOIL EROSION WILL BE DIVERTED TO A SAFE OUTLET. DIVERSIONS AND OTHER TREATMENT PRACTICES MUST CONFORM WITH THE APPROPRIATE STANDARDS AND SPECIFICATIONS.
- B. SEEDBED PREPARATION**
- SEEDBED PREPARATION IS NOT REQUIRED WHERE HYDRAULIC SEEDING AND FERTILIZING EQUIPMENT IS TO BE USED.
 - WHEN CONVENTIONAL SEEDING IS TO BE USED, SEEDBED PREPARATION WILL BE DONE AS FOLLOWS:
 - BROADCAST PLANTING.
 - TILLAGE AT A MINIMUM, SHALL ADEQUATELY LOOSEN THE SOIL TO A DEPTH OF 4 TO 6 INCHES; ALLEVIATE COMPACTION; INCORPORATE LIME AND FERTILIZER; SMOOTH AND FIRM THE SOIL; ALLOW FOR THE PROPER PLACEMENT OF SEED SPRIGS, OR PLANTS; AND ALLOW FOR THE ANCHORING OF STRAW OR HAY MULCH IF A DISK IS TO BE USED.
 - TILLAGE MAY BE DONE WITH ANY SUITABLE EQUIPMENT.
 - TILLAGE MAY BE DONE ON THE CONTOUR WHERE FEASIBLE.
 - ON SLOPES TOO STEEP FOR THE SAFE OPERATION OF TILLAGE EQUIPMENT, THE SOIL SURFACE WILL BE PITTED OR TRENCHED ACROSS THE SLOPE WITH APPROPRIATE HAND TOOLS TO PROVIDE A PLACE 6 TO 8 INCHES APART IN WHICH SEED MAY LODGE AND GERMINATE.
 - INDIVIDUAL PLANTS.
 - WHERE INDIVIDUAL PLANTS ARE TO BE SET, THE SOIL WILL BE PREPARED BY EXCAVATING HOLES, OPENING FURROWS, OR DIBBLE PLANTING.
 - FOR NURSERY STOCK PLANTS, HOLES SHALL BE LARGE ENOUGH TO ACCOMMODATE ROOTS WITHOUT CROWDING.
 - WHERE FINE SEEDLINGS ARE TO BE PLANTED, SUBSOIL UNDER THE ROW 3/8 INCHES DEEP ON THE CONTOUR 4 TO 6 MONTHS PRIOR TO PLANTING. SUBSOILING SHOULD BE DONE WHEN THE SOIL IS DRY, PREFERABLY IN AUGUST OR SEPTEMBER.
- C. LIME AND FERTILIZER -- RATES AND ANALYSIS**
- WHERE PERMANENT VEGETATION IS TO BE ESTABLISHED, AGRICULTURAL LIME SHALL BE APPLIED AS INDICATED BY SOIL TEST OR AT THE RATE OF 1 TO 2 TONS PER ACRE. AGRICULTURAL LIME SHALL BE WITHIN THE SPECIFICATIONS OF THE GEORGIA DEPARTMENT OF AGRICULTURE.
- LIME SPREAD BY CONVENTIONAL EQUIPMENT WILL BE "GROUND LIMESTONE." GROUND LIMESTONE IS CALCITIC OR DOLOMITIC LIMESTONE GROUND SO THAT 90 PERCENT OF THE MATERIAL WILL PASS THROUGH A 10-MESH SIEVE AND NOT LESS THAN 25 PERCENT WILL PASS THROUGH A 100-MESH SIEVE.
- AGRICULTURAL LIME SPREAD BY HYDRAULIC SEEDING EQUIPMENT WILL BE "FINELY GROUND LIMESTONE." FINELY GROUND LIMESTONE IS CALCITIC OR DOLOMITIC LIMESTONE GROUND SO THAT 98 PERCENT OF THE MATERIAL WILL PASS THROUGH A 20 MESH SIEVE AND NOT LESS THAN 70 PERCENT WILL PASS THROUGH A 100 MESH SIEVE.
- D. LIME FERTILIZER -- APPLICATION**
- WHEN HYDRAULIC SEEDING EQUIPMENT IS USED:
 - THE INITIAL FERTILIZER WILL BE MIXED WITH SEED, INOCULANT (IF NEEDED) AND WOOD CELLULOSE OR WOOD PULP FIBER MULCH AND APPLIED IN A SLURRY. THE SLURRY WILL BE AGITATED DURING APPLICATION TO KEEP THE INGREDIENTS THOROUGHLY MIXED. THE MIXTURE WILL BE SPREAD UNIFORMLY OVER THE AREA WITHIN ONE HOUR AFTER BEING PLACED IN THE HYDROSEEDER.
 - FINELY GROUND LIMESTONE WILL BE MIXED WITH WATER AND APPLIED IMMEDIATELY AFTER MULCHING IS COMPLETED OR IN COMBINATION WITH THE TOP DRESSING.
 - WHEN CONVENTIONAL PLANTING IS TO BE DONE, LIME AND FERTILIZER WILL BE APPLIED UNIFORMLY IN ONE OF THE FOLLOWING WAYS:
 - APPLY BEFORE LAND PREPARATION SO THAT IT WILL BE MIXED WITH THE SOIL DURING SEEDBED PREPARATION; OR,
 - MIX WITH THE SOIL USED TO FILL THE HOLES, DISTRIBUTE IN FURROWS; OR,
 - BROADCAST AFTER STEEP SURFACES AND SCARIFIED, PITTED OR TRENCHED.
 - A FERTILIZER PELLET WILL BE PLACED AT ROOT DEPTH.

(Ds3) DISTURBED AREA STABILIZATION (WITH PERMANENT SEEDLINGS)

NOT TO SCALE

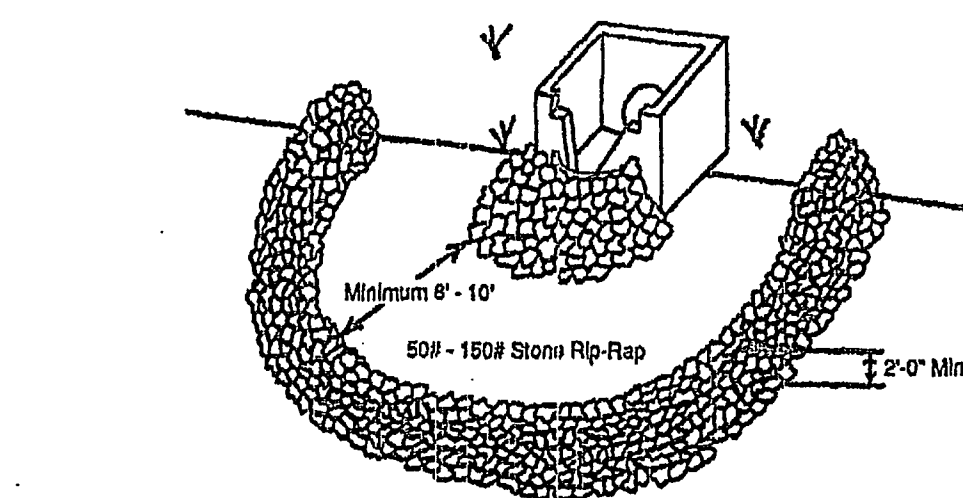

STONE FILTER RING

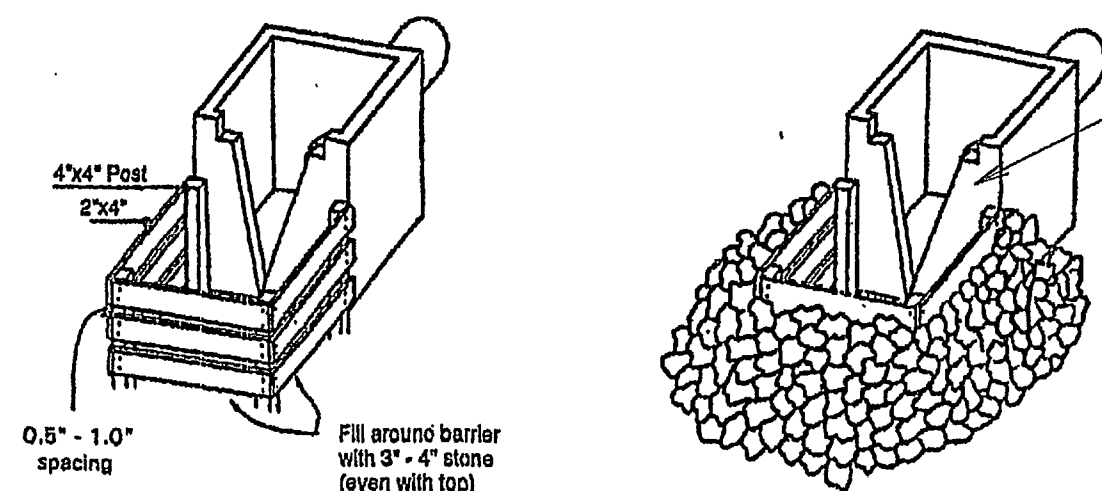

SLOTTED BOARD DAM WITH STONE FILTER

(Fr) FILTER RING AND (Rt) RETROFIT

NOT TO SCALE

THE FOLLOWING TYPES OF CHECK DAMS ARE USED FOR THIS STANDARD:

- STONE CHECK DAMS SHOULD BE CONSTRUCTED OF GRADING SIZE 2-10 INCH STONE. (SEE FIGURE). MECHANICAL OR HAND PLACEMENT SHALL BE REQUIRED TO INSURE COMPLETE COVERAGE OF ENTIRE WIDTH OF DITCH OR SWALE AND THAT CENTER OF DAM IS LOWER THAN EDGES.
- HAYBALE CHECK DAMS, STAKED AND EMBEDDED HAYBALES MAY BE USED AS TEMPORARY CHECKDAMS IN CONCENTRATED FLOW AREAS WHILE VEGETATION IS BECOMING ESTABLISHED. THEY SHOULD NOT BE USED WHERE THE DRAINAGE AREA EXCEEDS 2 ACRES. HAYBALES SHOULD BE EMBEDDED A MINIMUM OF 4 INCHES. (SEE FIGURE).

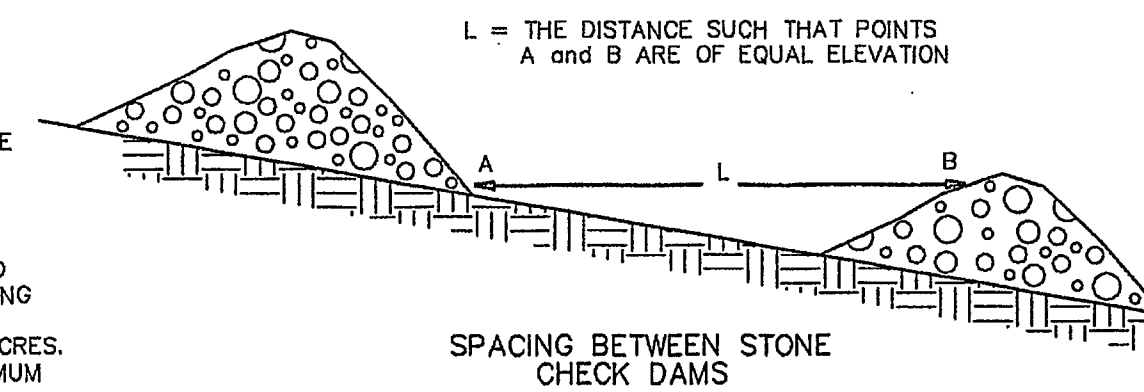

PERIODIC INSPECTION AND REQUIRED MAINTENANCE MUST BE PROVIDED. SEDIMENT SHOULD BE REMOVED WHEN IT REACHES A DEPTH OF ONE-HALF THE ORIGINAL DAM HEIGHT OR BEFORE. CHECK DAMS MUST BE REMOVED AT THE COMPLETION OF THEIR USEFUL LIFE. AFTER REMOVAL, THE AREA BENEATH THE DAM SHOULD BE SEEDDED AND MULCHED IMMEDIATELY.

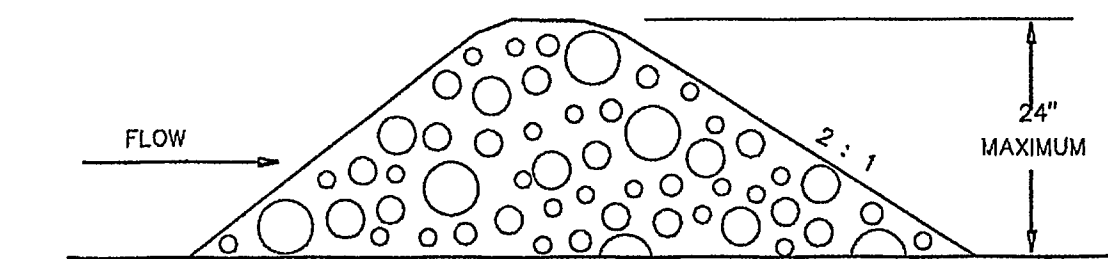
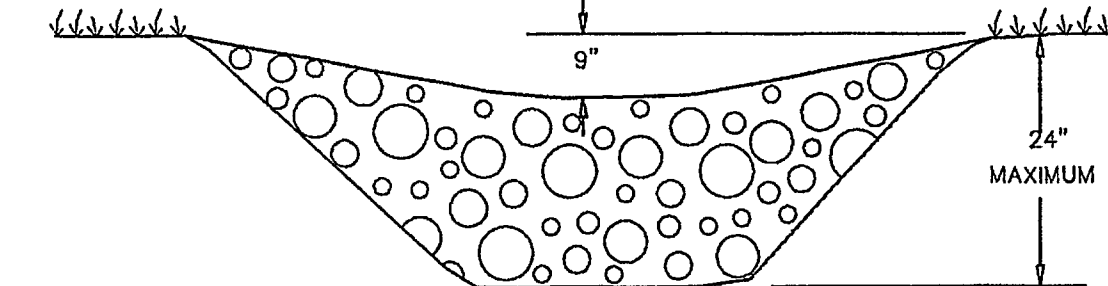

(Cd) CHECK DAM

NOT TO SCALE

BRUNDAGE ENGINEERING, INC.
 P.O. BOX 1926
 FAYETTEVILLE, GA. 30214
 770-719-0433

SITE DEVELOPMENT DRAWINGS FOR

PIT STOP (DOT ENTRANCE DRAWINGS)

LOCATED IN
 L.L. 186
 OF THE 13th DISTRICT
 CLAYTON COUNTY,
 GEORGIA

DATE	JOB NO.
JANUARY 18, 2005	00027
FILE NAME	SCALE
PITSTOP2rev6	1" = 20'

SHEET TITLE

EROSION AND SEDIMENTATION CONTROL DETAILS

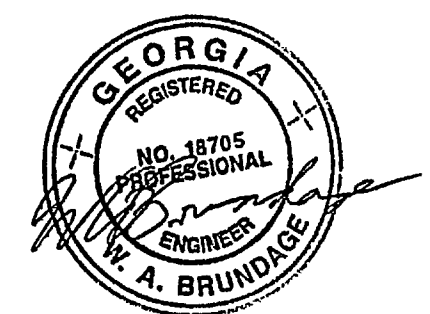

NO.	REVISIONS	DATE

SHEET NO.

5

SHEET 5 OF 5

RELEASED FOR CONSTRUCTION
 FOR REVIEW ONLY

(Sd1) CONSTRUCTION OF SILT FENCE

NOT TO SCALE

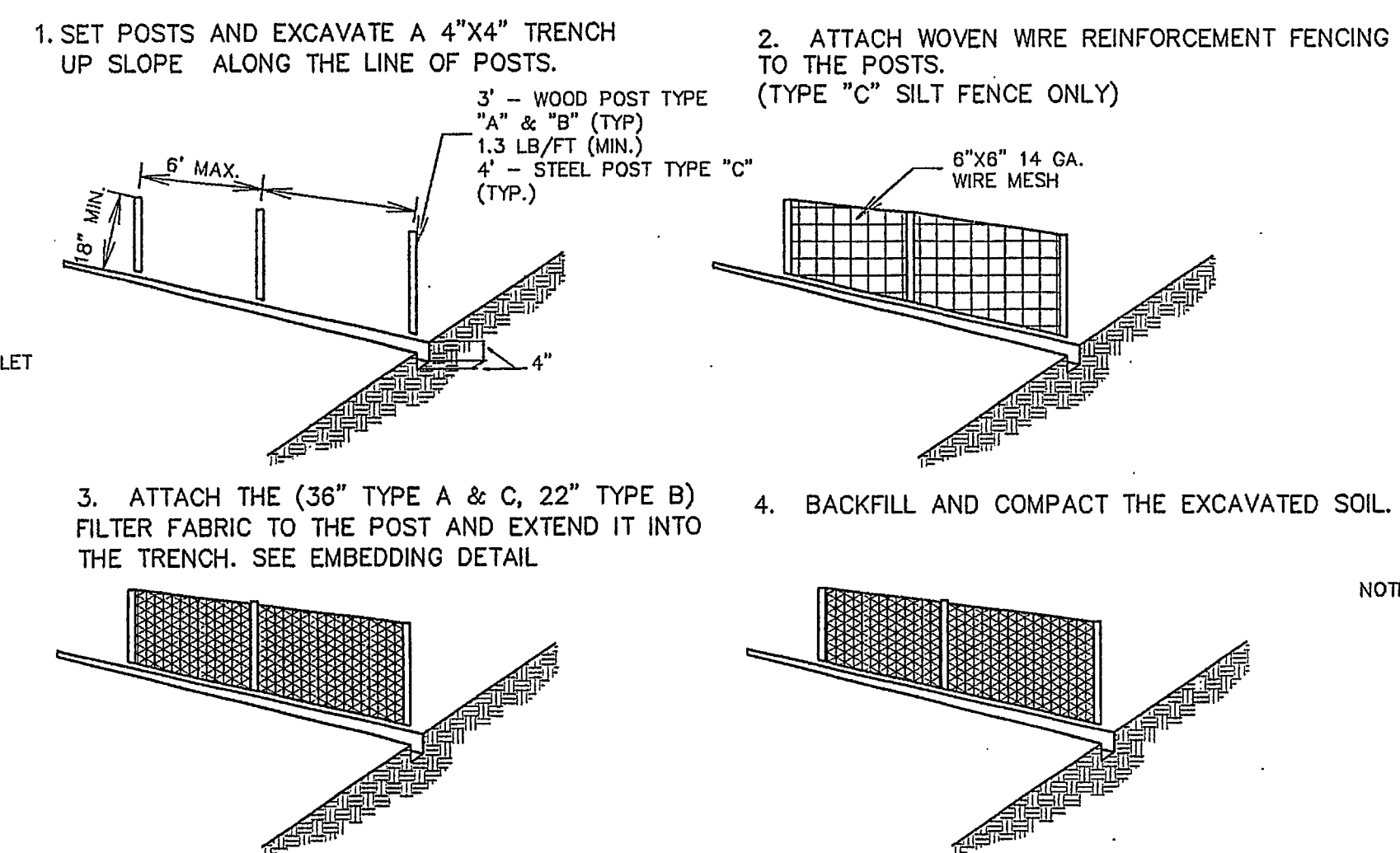

NOTE: GEO-TEXTILE FABRIC SHALL BE ERECTED WITH A WIRE BACKING TYPE "C" ONLY.

EMBEDDING DETAIL